



20 WOODRUFF ROAD · MORRISTOWN

20WOODRUFFROAD.COM

h | THE
SARITTE HAREL
TEAM BRINGING PEOPLE HOME

SARITTE HAREL: 973.713.9464 • SARITTE@HARELREALESTATE.COM
KIMBERLY MISITA: 201.230.2525 • KIMBERLY@HARELREALESTATE.COM

kw PREMIER
PROPERTIES
KELLERWILLIAMS.

Nestled in the highly sought-after section of Convent Station is this meticulously maintained Colonial home. Situated on over an acre of beautifully manicured park-like grounds, this residence boasts 4 bedroom, 2 full bath and 2 half bath across 2 finished levels.

Step inside to the freshly painted interiors accentuated by elegant crown moldings. The sun-filled living room boasts a wood-burning fireplace while the adjacent formal dining room includes a bay window with built-in bench seating, perfect for gatherings. Enjoy cozy family moments in the family room featuring built-ins, an additional fireplace and French doors leading to a charming 3-season screened-in porch.

The eat-in kitchen is a chef's dream with a large peninsula island, Silestone countertops, abundant wood cabinetry with under-cabinet lighting, neutral tiled backsplash, stainless steel appliances and sliders to the oversized deck. Conveniently, the first floor also features two powder rooms and a laundry room with deck access.





Retreat to the primary suite upstairs which includes two spacious closets and an updated en-suite bathroom with glass enclosed tiled shower. Three additional generously sized bedrooms share an updated hall bathroom with shutters and a glass-enclosed shower/tub.

Immerse yourself in outdoor bliss on the large deck or relax in the spacious three season screened-in porch as you take in the serene views of the sprawling private backyard.

Located just 0.5 miles from Normandy Park Elementary School and easy access to Rt. 287, Rt. 24, Rt. 10, and NJT, this home is perfect for families and commuters alike.



PARTICULARS

- Meticulously maintained Colonial home in highly desirable Convent Station
- Built in 1966
- 4 bed, 2 full baths, 2 half bath
- Property lot size: 1.11 acres
- 2 finished levels of living space
- 0.5 miles from Normandy Park Elementary school
- Close proximity to Rt. 287, Rt. 24, Rt. 10 and NJT

HIGHLIGHTS

- Freshly painted interior
- Welcoming foyer with tiled floors
- Spacious living room with bay window and wood-burning fireplace with black and white tiled accents

20WOODRUFFROAD.COM



SARITTE HAREL
973.713.9464
saritte@harelrealestate.com



KIMBERLY MISITA
201.230.2525
kimberly@harelrealestate.com

- Family room featuring built-ins, wood-burning fireplace with brick and white mantle and French doors leading to spacious 3 season screened-in porch
- Large dining room with crown molding and bay window with built-in bench seating
- Two convenient first floor powder rooms
- Eat-in kitchen with large peninsula island, Silestone countertops, abundant wood cabinetry with under cabinet lighting, neutral tiled backsplash, stainless steel appliances including double wall ovens, pantry and sliders to oversized deck
- First floor laundry room with large closet and access to deck
- Primary suite featuring 2 spacious closets, one reach-in and one walk-in, with updated en-suite bathroom featuring glass enclosed tiled shower, shutters and vanity with ample storage space
- Three additional generously sized bedrooms located on the second floor share an updated hall bathroom with shutters and glass enclosed shower/tub

- Generously oversized unfinished basement with sperate large storage area. Finishing potential
- Recessed lighting
- Carpet and tile flooring
- Crown molding
- Multi-zone central AC
- Heat: Forced hot air

EXTERIOR

- New front paver walkway
- Charming covered front porch
- Spacious 3 season screened-in porch with skylights, ceiling fan and pristine views of the park-like backyard
- Oversized wood deck
- Sprawling private backyard with mature landscaping and beautifully manicured grounds
- Underground multi-zone sprinkler system
- Exterior: Wood shingles
- Roof: Asphalt
- 2 car oversized attached garage
- Paved driveway with additional parking

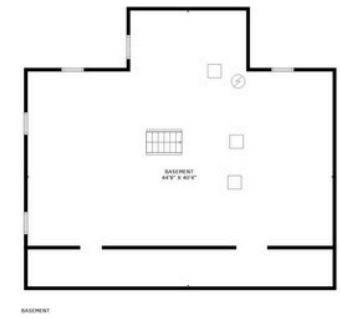

Ranked Top 1% NJ Realtors*

Top 5 Real Estate Agents in NJ*

NJAR Circle of Excellence Sales Award 2007-2023

* Per GSMLS 2023 *Per RealTrends 2024
Each Office is Independently Owned and Operated